



Starlink + CommBox™ Edge

A Powerful Connectivity Combination

Effective May 16, 2024

Rely on the speed of Starlink and the Support of KVH

Bringing connectivity to your yachts and your customers has never been so easy. Enhance your onboard communication offerings with Starlink and KVH, a world leader in marine connectivity.

Contact KVH Sales today at sales@kvh.com to discuss how we can bring the best connectivity onboard.

The Premier Starlink/Network Management Solution for OEMs

Deliver a comprehensive Starlink and network management solution to your customers when you select Starlink with KVH's CommBox Edge Communications Gateway, the most powerful network and bandwidth management solution available.

5 Reasons why KVH and Starlink Give Your Vessels and Customers the “Edge” They Need

Starlink offers blazing speeds and low costs but no native controls to manage data use, data speeds, allowed applications, or how Starlink interacts with other communications and your onboard networks.

CommBox Edge from KVH changes all that, equipping Starlink and your boats with:

1. Complete Maritime Package for Easy Installation, Testing, and Activation

- Starlink terminals in stock with same-day shipping and all necessary components for a successful marine installation with optional parts and accessories available for purchase
- Choice of the CommBox Edge 6 and Edge 2 below deck units (no Starlink router required!)
- Temporary CommBox Edge activation to confirm configuration and operation during factory installation
- Simple CommBox Edge and Starlink activation when your customer is ready with complimentary consultations
- Starlink parts and accessories available for purchase
- Intuitive GUI for on vessel management by senior crew/captain

2 Advanced Network Configuration and Performance Options

- Support for as many as 12 WANs and 30 LANs
- Dynamic WAN prioritization and connection balancing to boost efficiency
- Combine multiple Starlinks and increase data speeds
- High-availability configurations ensure exceptional reliability
- Versatile data, user, and application management rules
- Bond Starlink with 5G, Wi-Fi or other LEO services

3. Exclusive Starlink Resources

- Starlink data, network, and usage management tools
- Starlink bandwidth and data speed controls
- Accessible via KVH Manager and the CommBox Edge suite of tools

4. Secure Control, Reporting, and Service Capabilities

- Cloud-managed user interface and mobile application
- Single pane of glass fleet-wide view and easy zero-touch configuration clone capabilities
- Real-time data monitoring and analysis
- Network protection with deep packet inspection, traffic policies, and VPN with no slowdowns thanks to unlimited PEP
- Remote service access to any networked device

5. KVH's Unmatched Support

- KVH's 24/7/365 airtime and technical support – call KVH and a trained KVH professional will always answer with no emails and no delays, just expert attention and premium service
- Global field service with factory-trained technicians
- Warranty replacement units in advance, shipped to the boat's current location (rather than the billing address)
- Starlink parts and accessories available for purchase



Onboard Edge Computing Designed for Marine Use

CommBox Edge offers a powerful and versatile on-vessel addition to your network infrastructure. Integrate and manage all of your onboard connectivity with marinated solid-state design and high-availability configurations.

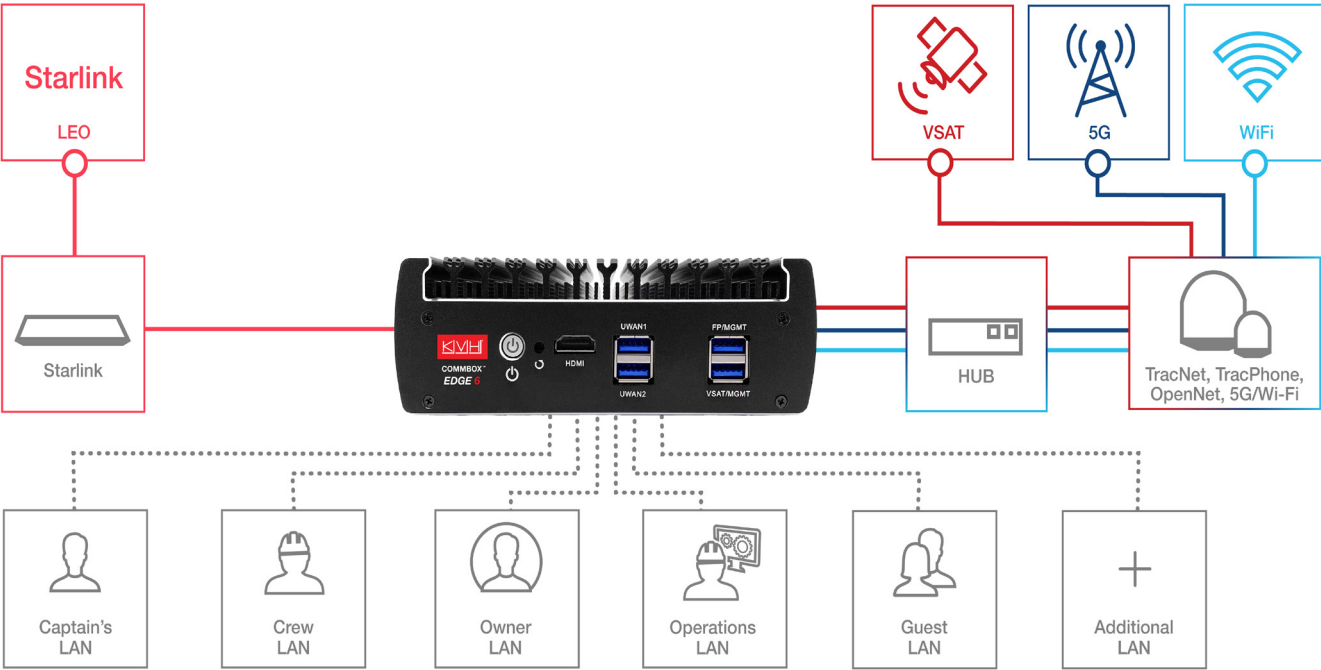

The CommBox Edge features provide core functionality or advanced controls, based on your unique needs.

Features		
✓ Max. 12 WAN Connections	✓ Standard Bonding (<i>Load Balancing</i>)	✓ WAN Acceleration
✓ Max. 30 LAN Connections	✓ Advanced Bonding	✓ Configurable WAN Quotas
✓ Content Filtering per LAN & Device	✓ VPN (<i>Enterprise Extension</i>)	✓ Secure Remote Access (<i>Device Level</i>)
✓ Firewall	✓ High-speed VPN Links (<i>PEP</i>)	✓ Events Alerting
✓ Deep Packet Inspection	✓ Configurable POP Egress (<i>US or UK</i>)	✓ Crew Portal & Allocations

www.kvh.com

KVH Industries A/S
EMEA Headquarters
Birkeroed, Denmark
Tel: +45.45.160.180 Fax: +45.45.160.181
Email: info@emea.kvh.com

KVH Industries, Inc.
World Headquarters
Middletown, RI U.S.A.
Tel: +1.401.847.3327 Fax: +1.401.849.0045
Email: info@kvh.com

KVH Industries Pte Ltd.
Asia-Pacific Headquarters
Singapore
Tel: +65.6513.0290 Fax: +65.6472.3469
Email: info@apac.kvh.com